

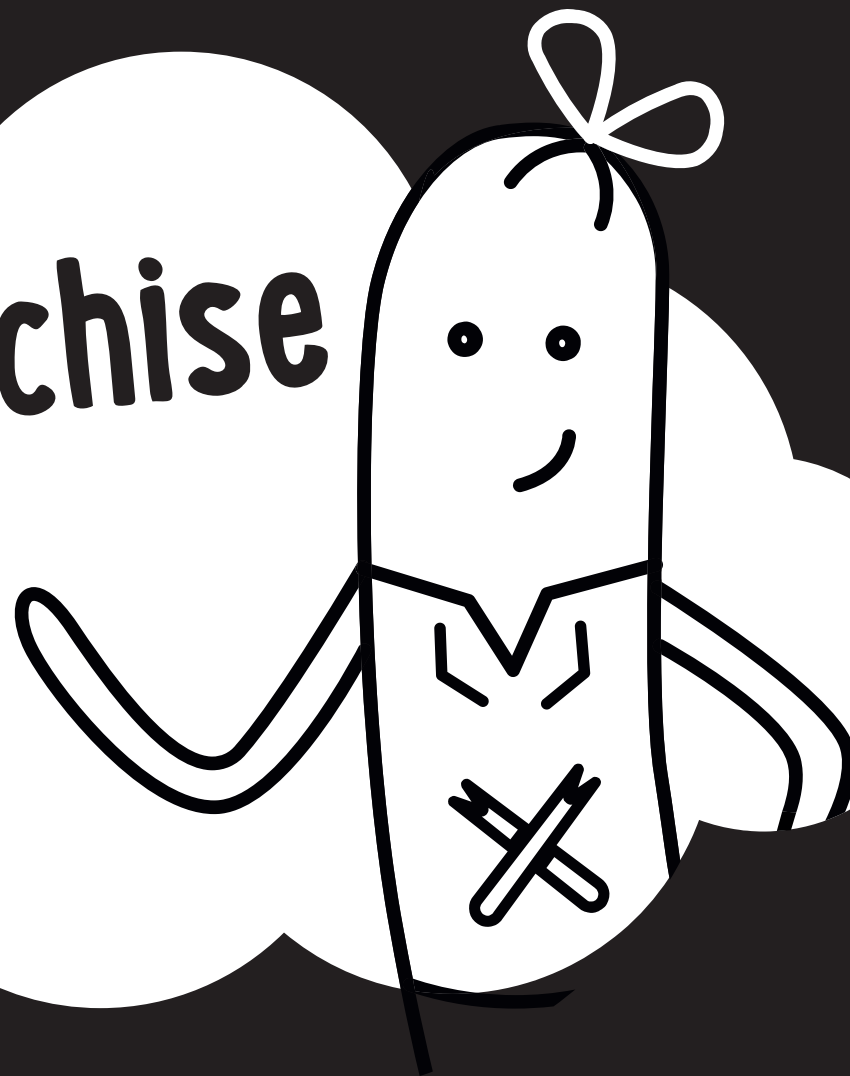

**Extrawurst**<sup>®</sup>  
*simply. better.*

Authentic German Bratwurst

**Franchise  
Me**



CONTAINER STYLE

**MIDI 20**



Upstand with halo lit logos  
Artwork to be provided by client

Logo / slogan above hatch  
Artwork to be provided by client

door to rear  
710 clear opening



Extraction & flue system to be detailed internally

offset Serving hatch (approx 3800mm width)

Partition wall & walkway RED

Display screen (49")

Composite Wood Effect Cladding  
Client spec'd colour - similar to "valley oak"

Steampunk Lighting under hatch

Front fascia material to match cladding

Customer Counters to be RED

Second serving hatch (offset, approx 1900mm opening)

**Customer Signature to Approve :**

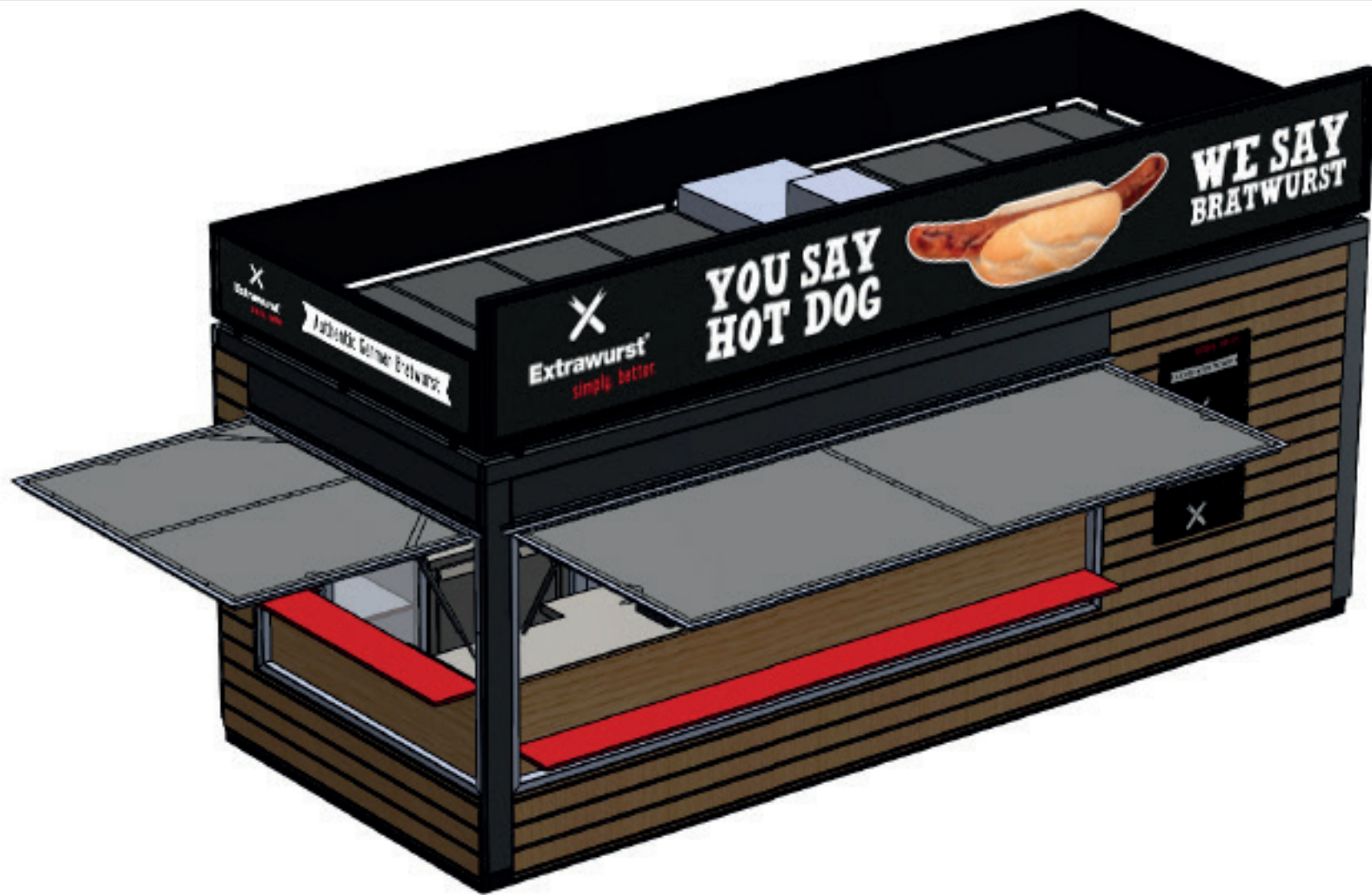

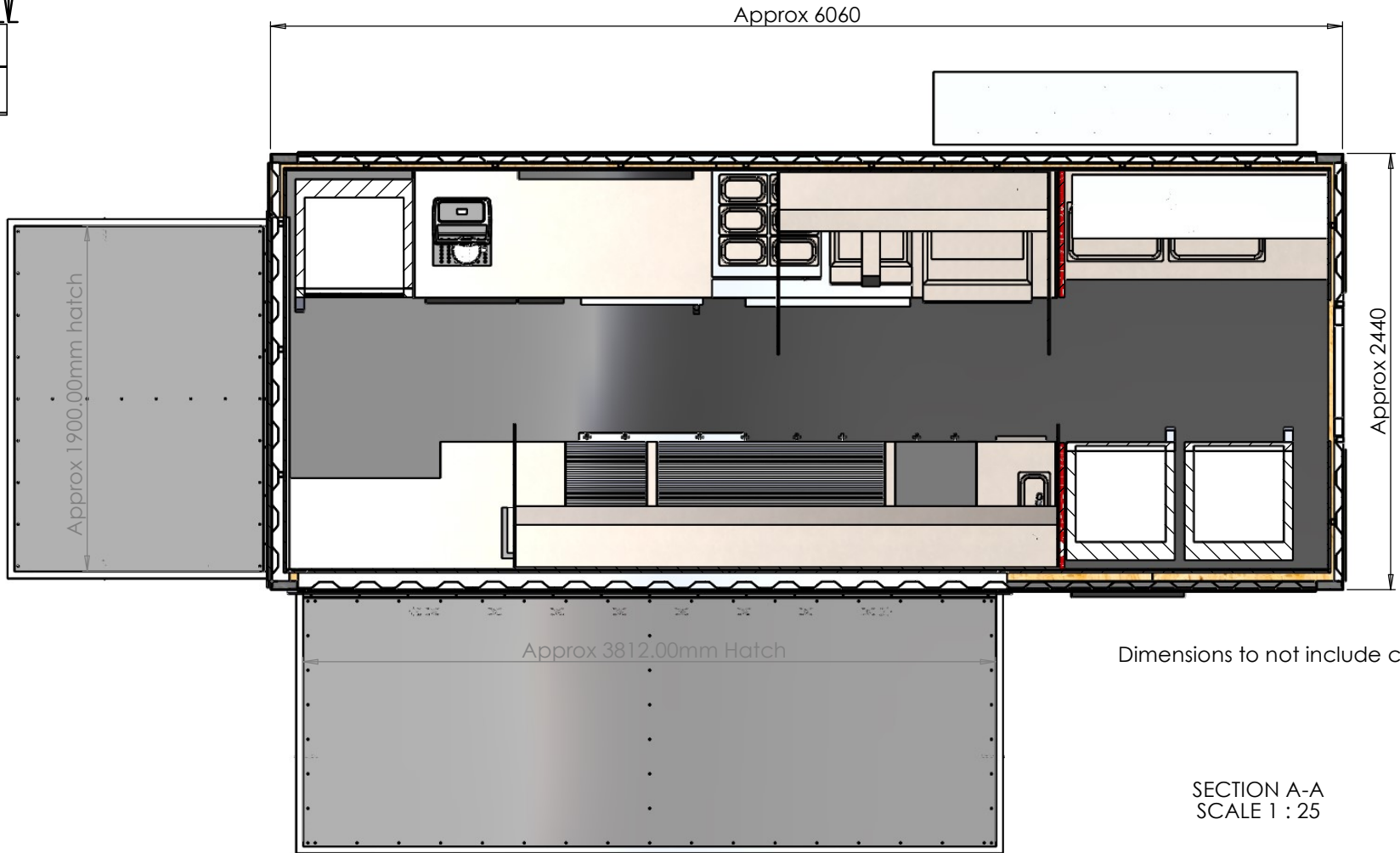
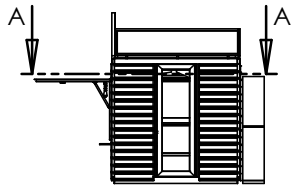

Dimensions to not include cladding

SECTION A-A  
SCALE 1 : 25

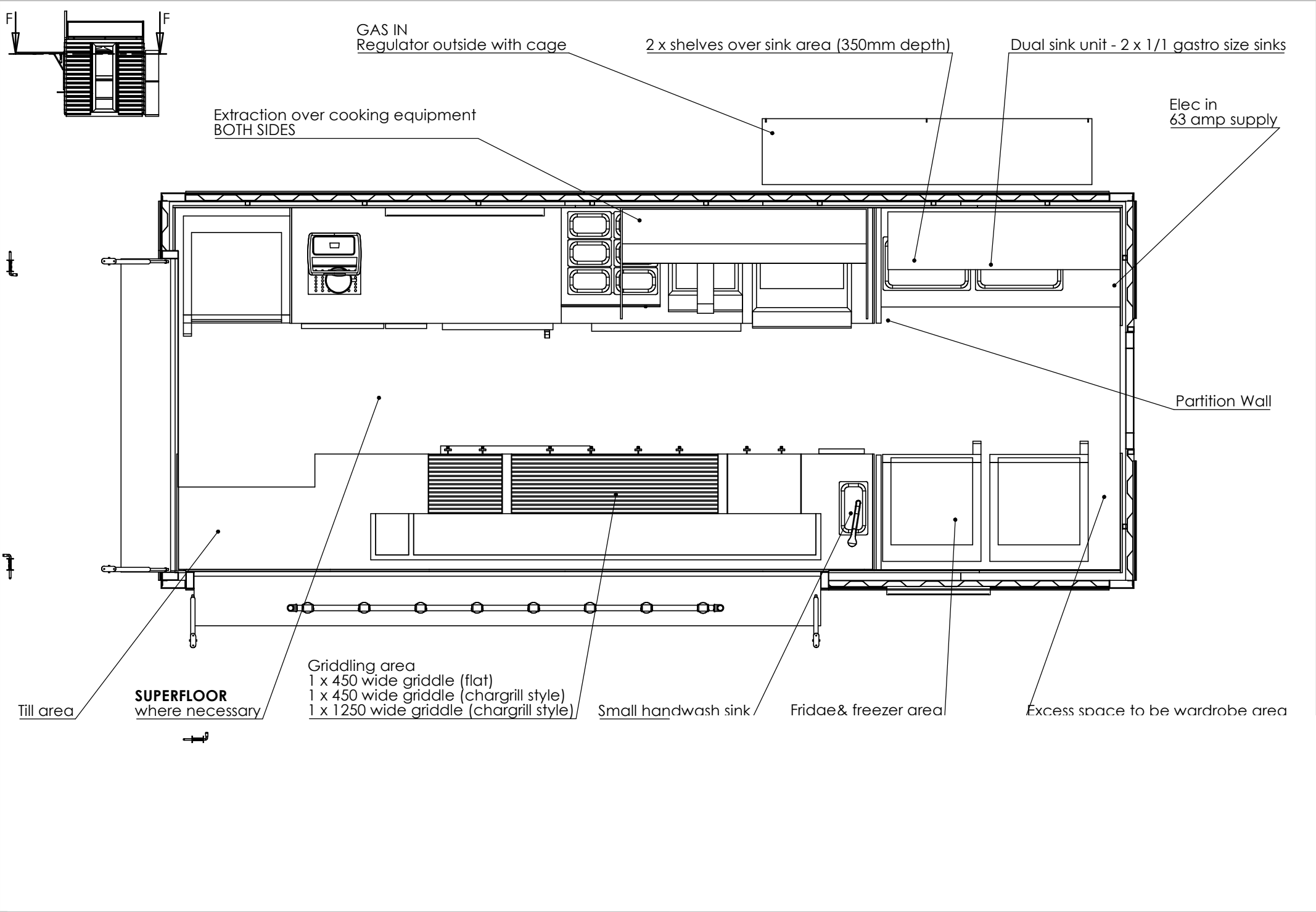

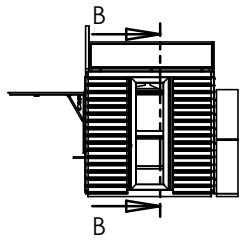

Feature wall finish - Black faux tiles

Stainless steel behind fryer

Sink area with shelves & cupboards



Likely gas in - accessed externally

Stainless steel cupboards

Blocked in where possible - stainless steel

130.34

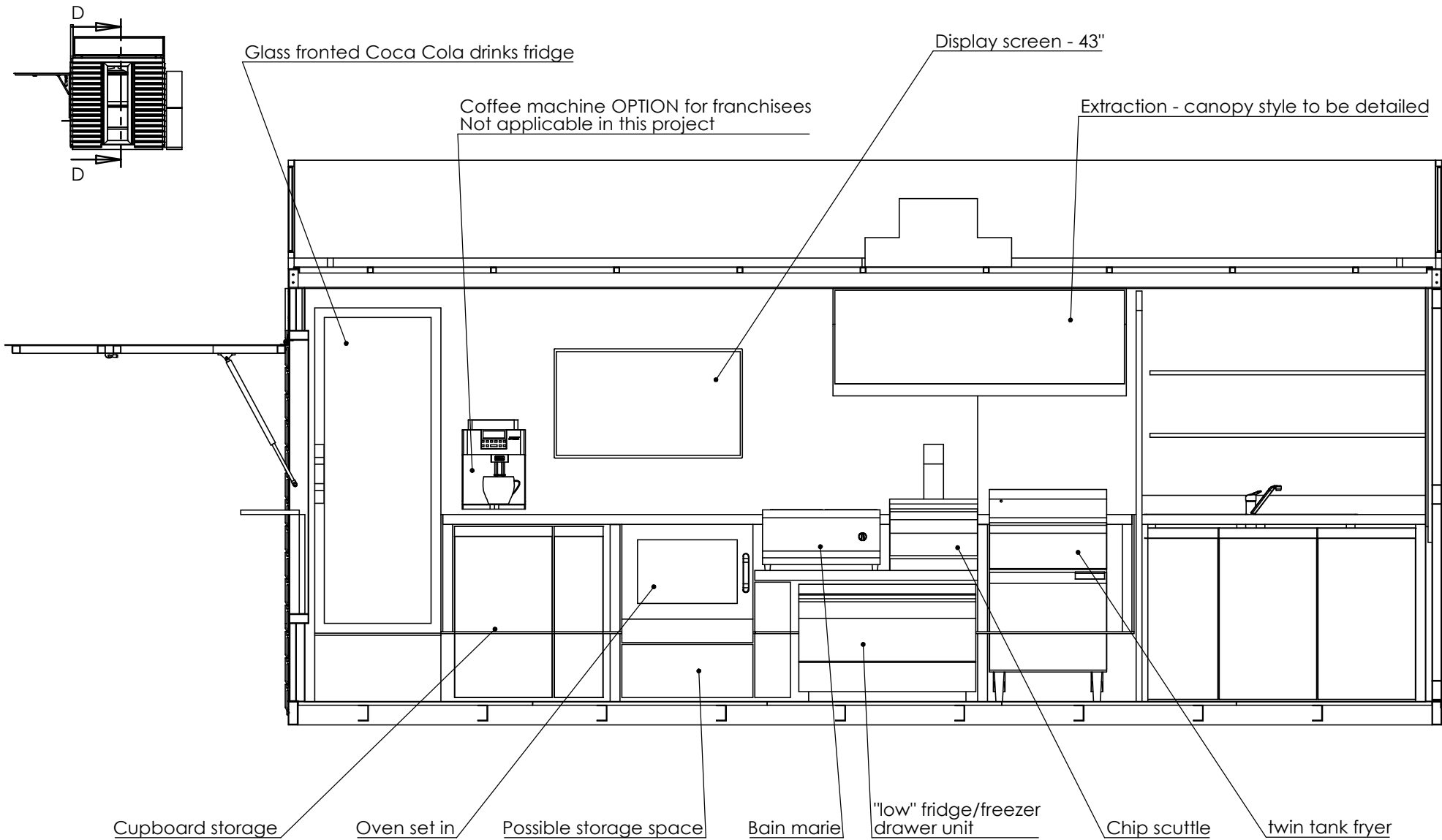

**Proposed Layout. Drawings are for guidance only.  
 Positioning of features subject to minor alterations.**



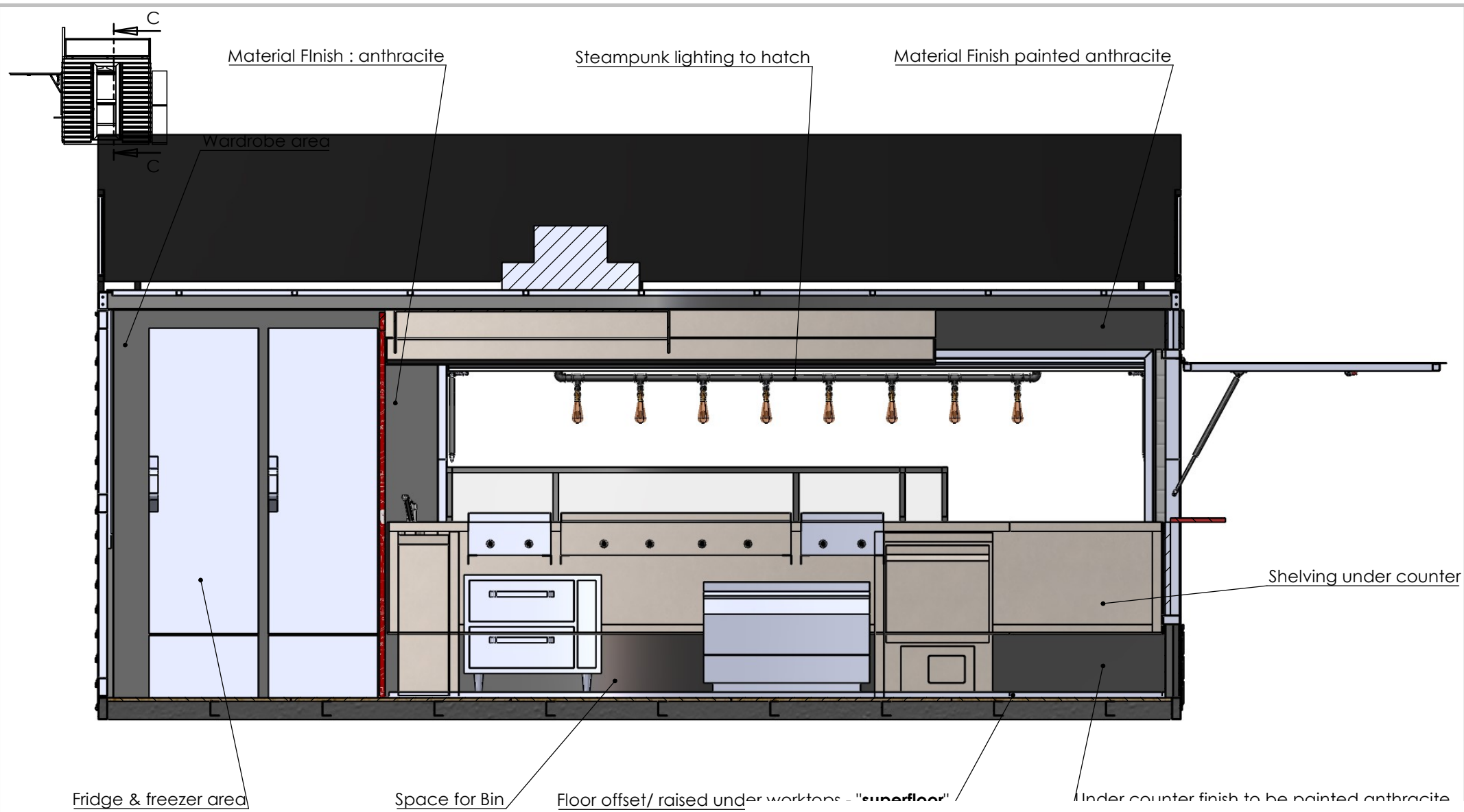



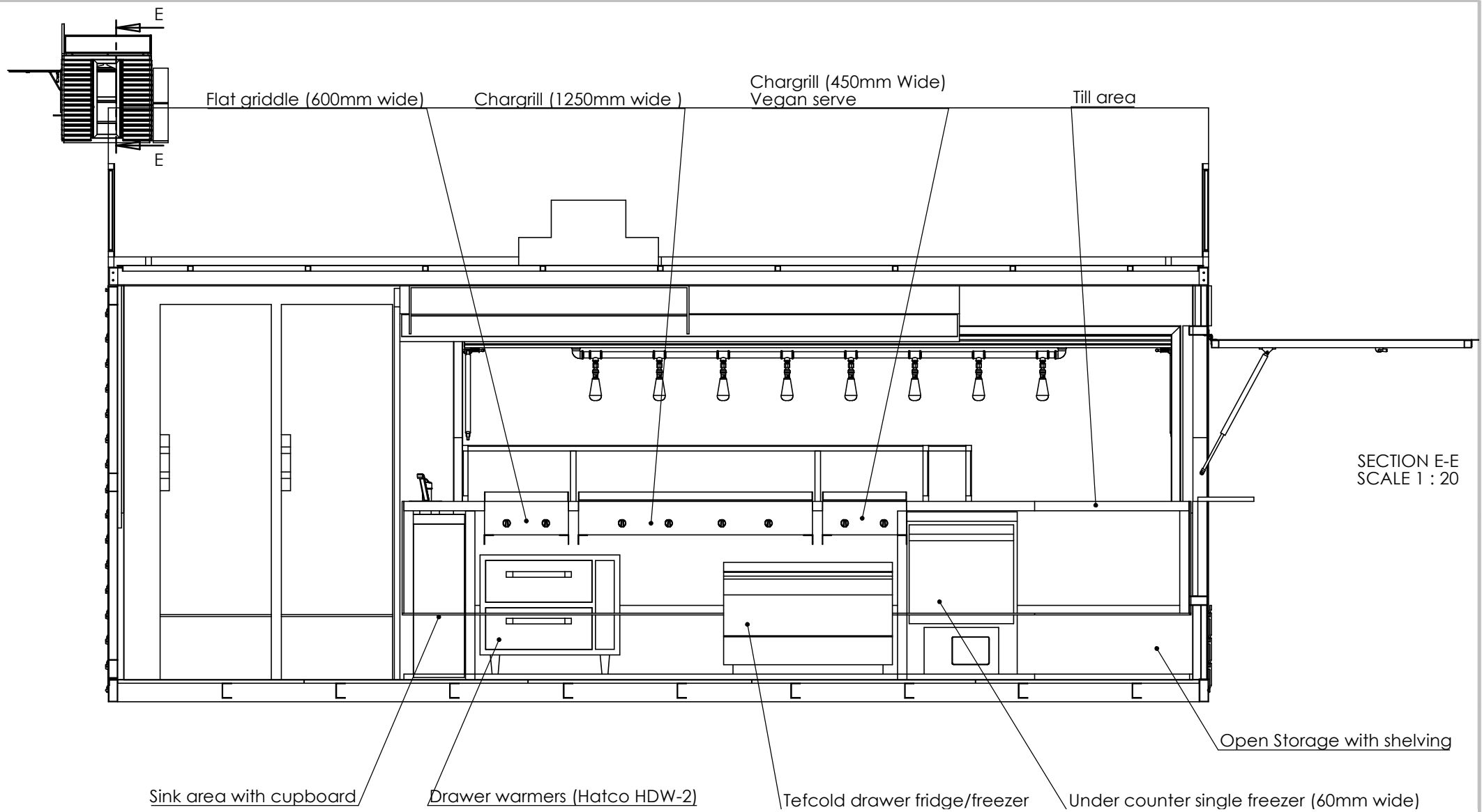

Proposed layout. Drawings are for guidance only.

SPECIFICATION			AMOBX OFFICE USE	
Item	Finish	Notes	Materials	In stock?
Conversion Type	20ft Kiosk			
Door Type	Personnel door over hitch			
Hatch Side	Dual offset	Approx opening: 1 x 1900mm wide 1 x 3800mm wide		
External Finish	Cladded - to closely match "valley oak" if possible			
Header Board	None			
Internal Feature Wall	Black faux tiles (composite tile board) Partition wall : red alcopan or similar	Stainless steel surround to cooking equipment		
Internal Hatch Wall	Painted Anthracite			
Hatch Lighting	Steampunk	Extra internal downlighting where necessary		
Feature Wall Lighting	Standard			
Lightboard	Painted Anthracite	Hatch		
Rear Worktop Material	Stainless steel			
Front Worktop Material	Stainless Steel			
Customer Fold out	RED	Red alcopan or similar		
Front Facia	To closely match "valley oak"	To match external		
Floor	Non-Slip	SUPERFLOOR Raised floor under counters		
Under Counter wall finish	Painted - anthracite			
Ceiling colour	Anthracite			
Under flap colour	Anthracite			
Sinks	XL - two sink areas	2 x XL (1/1gastro) behind partition, handwash sink next to partition		
Water Heater	Propex			
Tap	Chrome	x 2		
Electrical Tech Panel				
Logo	Display screen			
Plug Sockets	Where needed	Final locations TBC		
Electric Supply	63 amp single phase	elec in at wardrobe area		
Gas Supply	Input feature wall side - see drawing			

EQUIPMENT						AMOBX OFFICE USE				
Description	Spec	Notes	Make / Model	Client Supplied :	Amobox Supplied :	Fuel Type		Spec Sheet?	Ordered?	Arrived?
						LPG (kW)	ELECTRIC (kW)			
Griddle 1	450 Wide flat griddle	Lincat Silverlink 600	Lincat GS4/P	1						
Griddle 2	450 wide chargrill	Linkcat Silverlink 600	Lincat CG4/P	1						
Griddle 3	1250 wide chargrill		KSF RGS 125	1						
Fryer	Twin Tank 600 wide	150mm from wall (if material is not non-combustible)	Lincat J10/N	1						
Oven	set into cupboard front	as far right as possible	Lincat CO343M	1						
Chip Scuttle	450mm wide	Sunken to suit tefcold fridge	Lincat CS4/G							
Bain Marie	6 pot	Sunken to suit tefcold fridge	Lincat BM6CW	1						
Heated Drawers	2 drawer	Under griddles	Hatco HDW-2	1						
Extraction Canopy	both sides of equipment	To be detailed on build			2					
Display Screen	43"	internal		1						
Display Screen	49"	external		1						
Fridge 1	Tall fridge approx 600mm wide	back of house area	Tefcold UR400S	1						
Fridge 2	Tall display drinks fridge, glass fronted. approx 650mm wide	coca cola branded	icool 500	1						
Fridge 3	drawer unit "low fridge"	dual temp fridge OR freezer	Tefcold UD1-2	1						
Freezer 1	Tall freezer approx 600mm wide	back of house area	Tefcold UF400S	1						
Freezer 2	Single door approx 600mm wide		Liebherr GGU 1550	1						
Sneeze Guard	Bespoke made by AMOBX	Inc. bread box end			1					
			<b>Total (kW) :</b>							

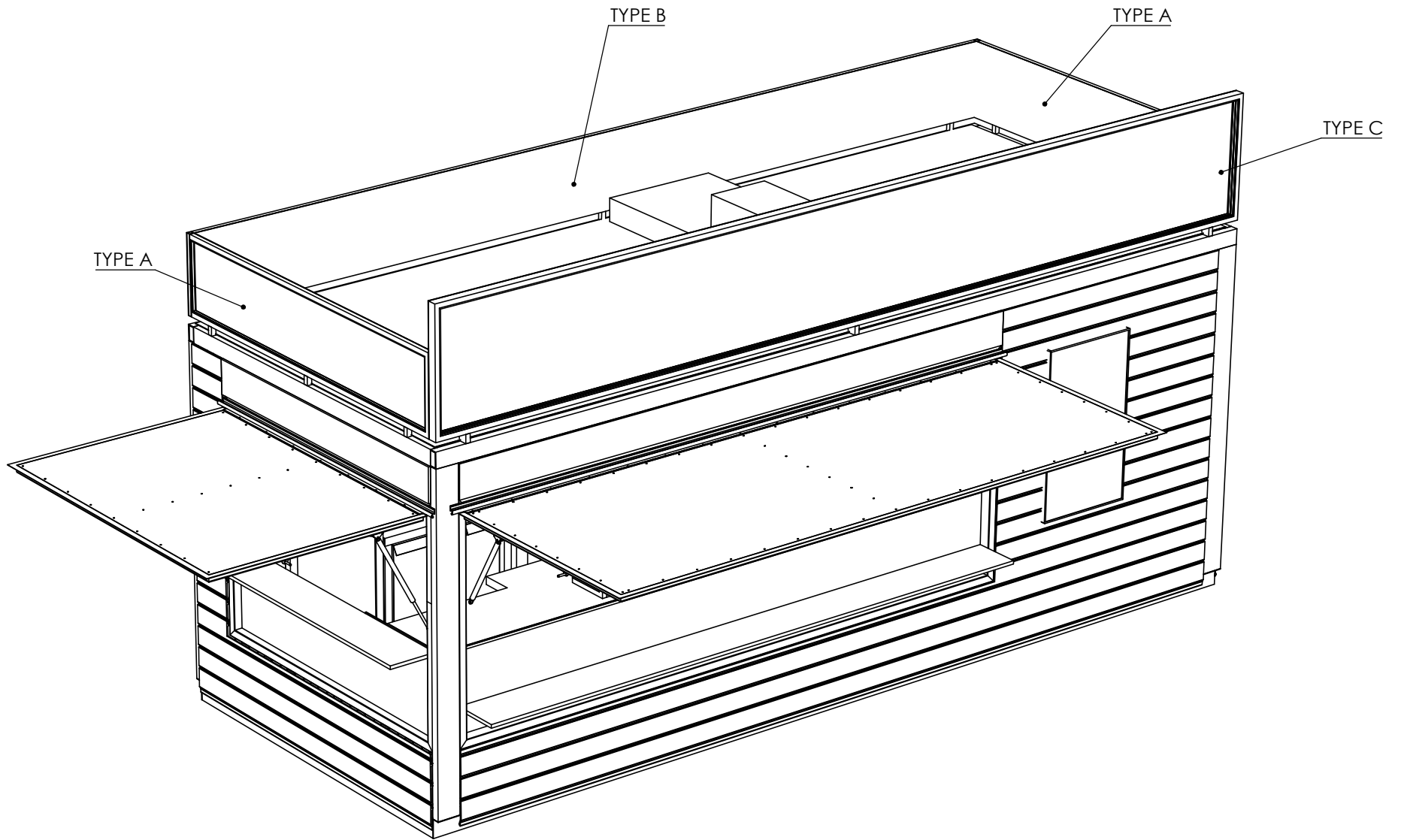

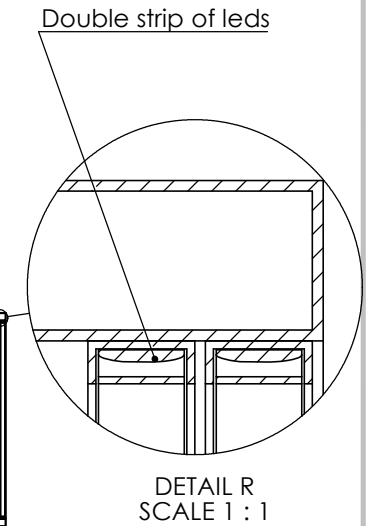
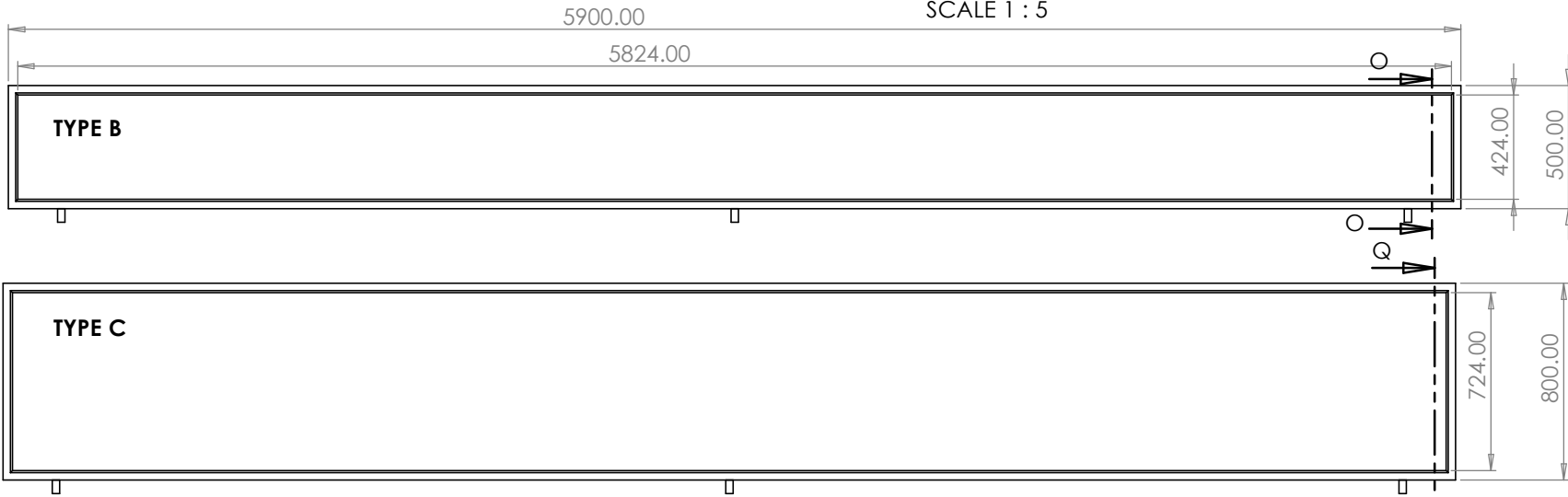
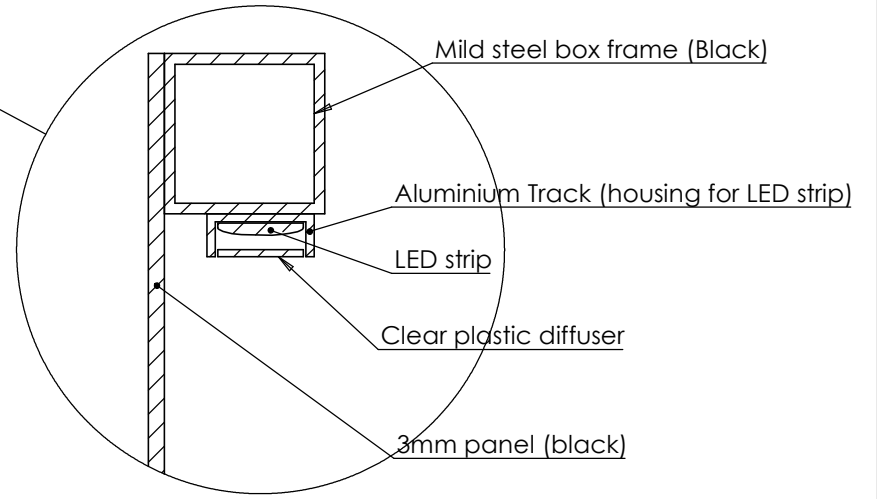
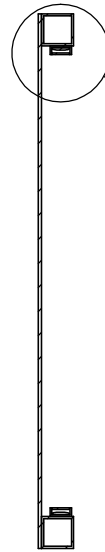
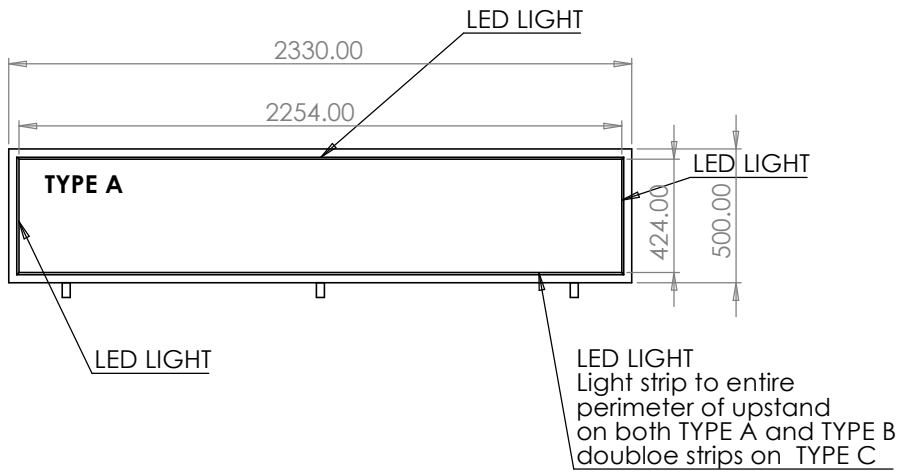



**Extrawurst®**

simply. better.

**Authentic German Bratwurst**



Upstand with halo lit logos  
Artwork to be provided by client

Logo / slogan above hatch  
Artwork to be provided by client

door to rear  
710 clear opening



Extraction & flue system to be detailed internally

offset Serving hatch (approx 3800mm width)

Partition wall & walkway RED

Display screen (49")

Composite Wood Effect Cladding  
Client spec'd colour - similar to "valley oak"

Steampunk Lighting under hatch

Front fascia material to match cladding

Customer Counters to be RED

Second serving hatch (offset, approx 1900mm opening)

**Customer Signature to Approve :**